



Role: Panel Member



Log in

1) Go to : <https://cpms.ern-net.eu/login/>

You can Login to the CPMS ERN through the EU Login Authentication Service.

➔ Login via EU Login

2) Enter your Password

Password

3) Choose one verification method (Need your mobile)

Choose your verification method

EU Login Mobile App PIN Code



4) Click on «**Sign in**»



Sign in

ERN-EYE Helpdesk



Step 1: Log in



1. You receive an e-mail inviting you to join a Panel.
2. Log in to the CPMS at <https://cpms.ern-net.eu/login/>.
3. Click on «ERN» button.
4. Click on the «Dashboard» button and select the corresponding panel from the «Panel Invitations».

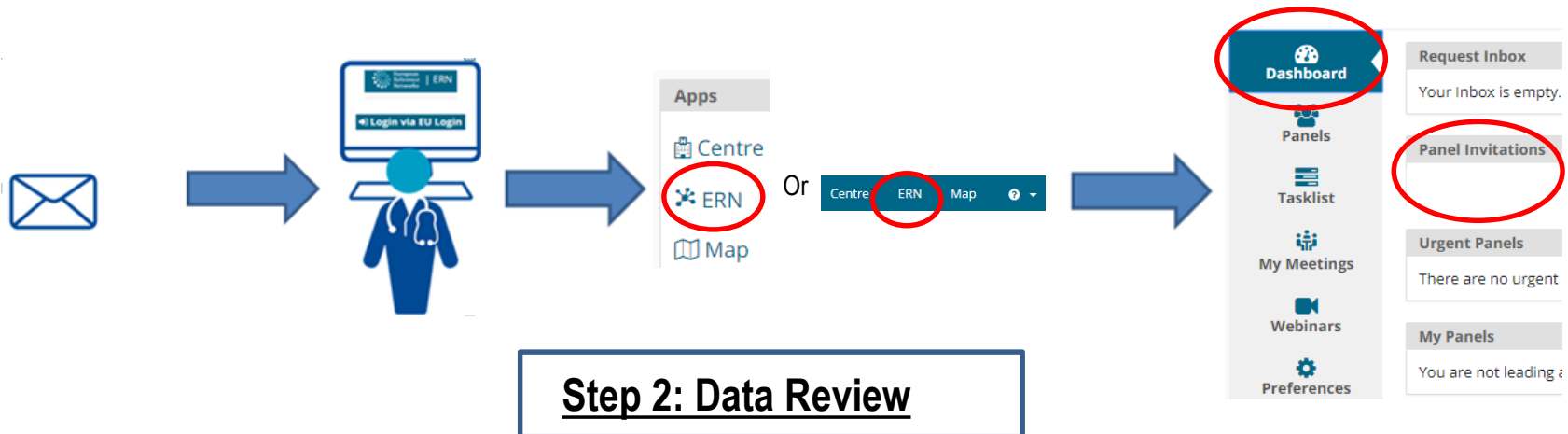

Step 2: Data Review

1. Review the data concerning the patient.
2. Participate in a web meeting to discuss the case if you have been invited.
3. You can also request additional data or schedule a web meeting.

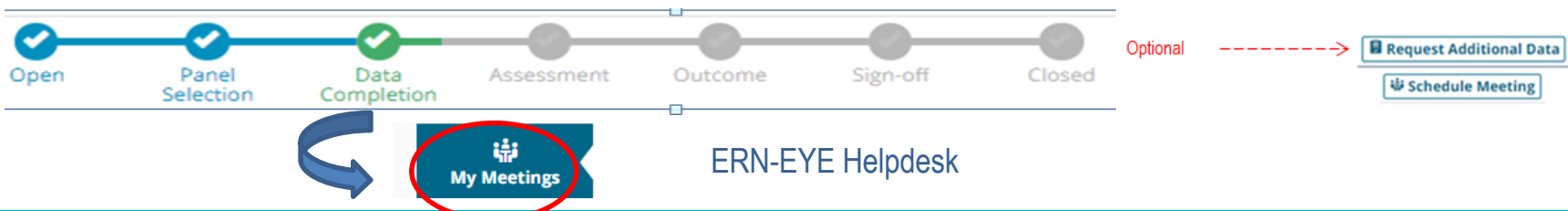



Step 3: Assessment

1. To give your opinion on the case, click on «Record Contribution» button.
2. To record your contribution write an assessment in the free text field or upload a file.

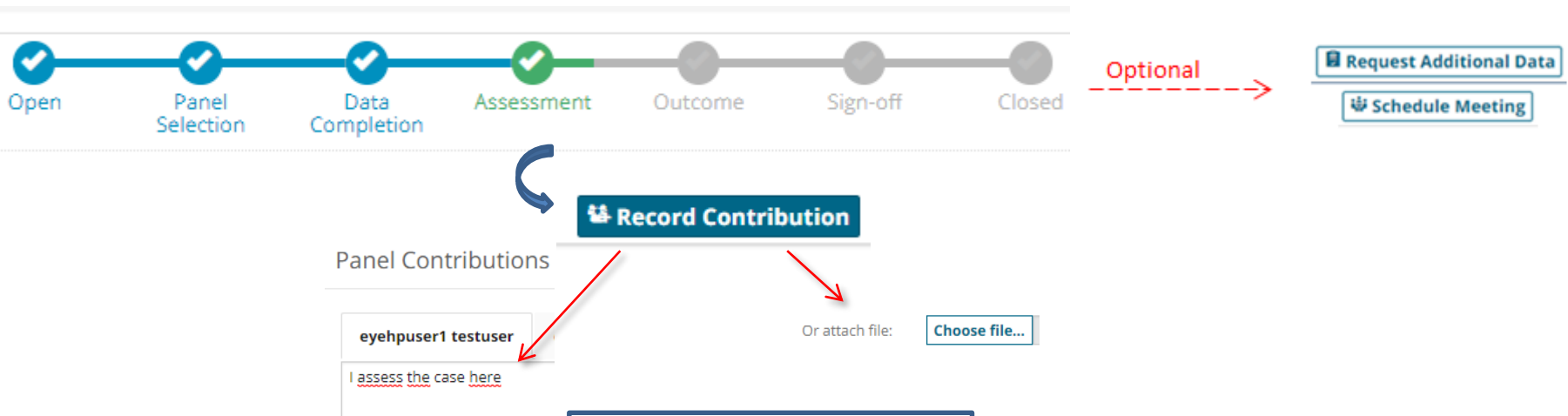

Step 4: Outcome

1. Click on «View Outcome» to review Panel Outcome Document (a draft version).
2. Discuss the draft outcome using the timeline on the right of the screen.

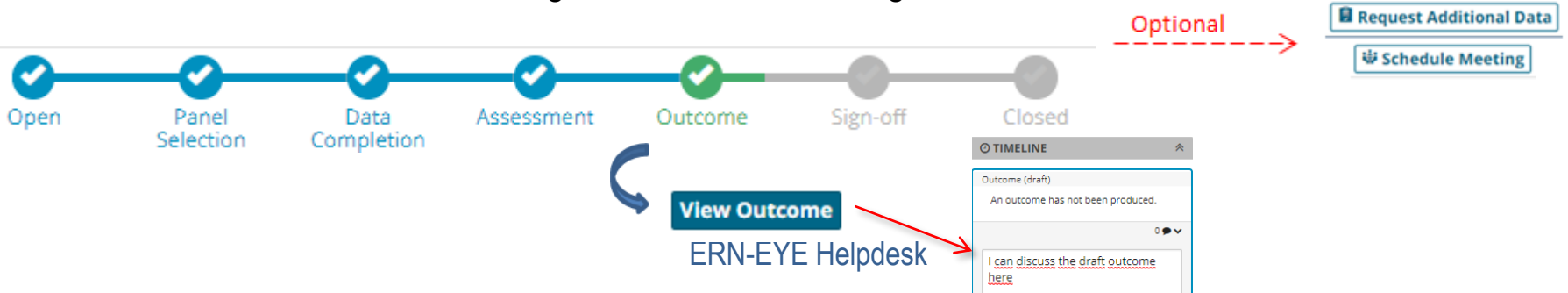



Step 5: Sign-off



1. You can download the «Outcome Document» (.pdf) once it has been signed off by the Panel Lead.

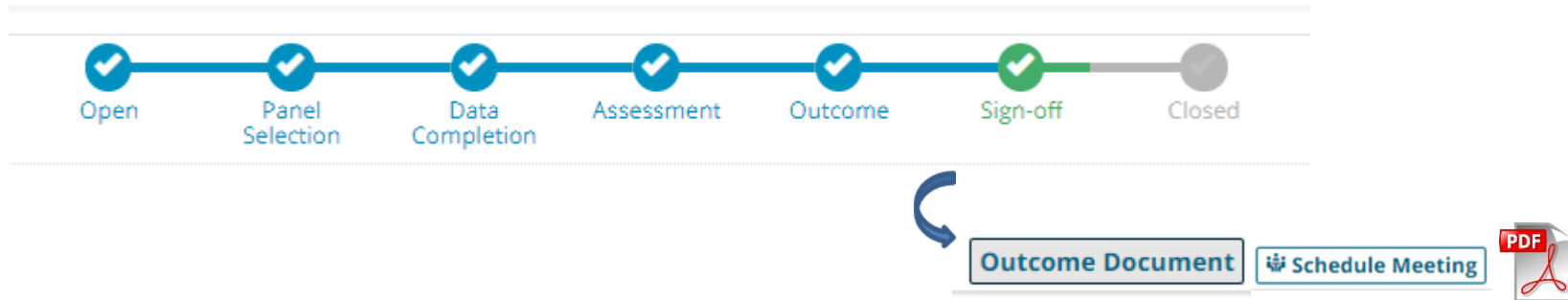

Step 6: Closed and archived

1. You can still download the «Outcome Document» once the Panel Lead has closed the panel.
2. Panel Lead can also decide to archive the panel (**with the coordinator's agreement**).
3. Once archived, the panel is only visible to the enrolling center.

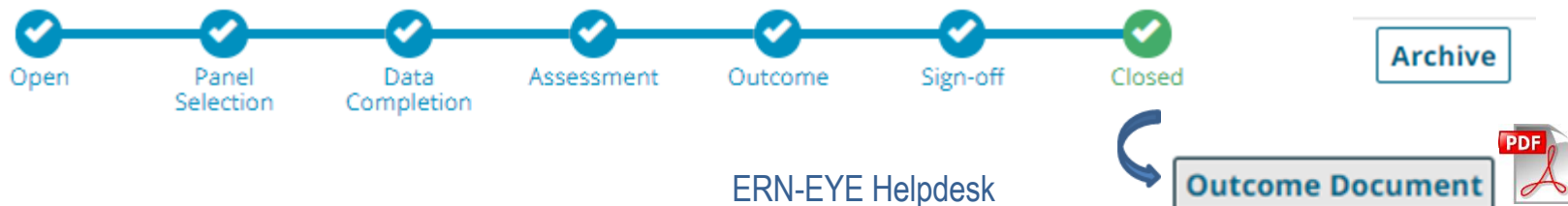



Reminder:

After logging out, you can go back to your panel by logging in again



Sign in

at: <https://cpms.ern-net.eu/login/> and following all steps described **on page 2.**

- Then click on «**ERN**» in left margin or at the top of the page

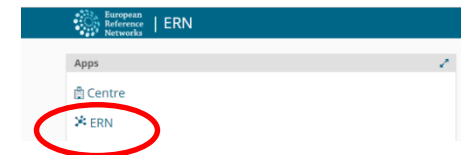

- Then click on «**Dashboard**» and select the corresponding panel in «**Contributing Panels**»



Panel ID	Date	Nickname
#42	18/04/2019	Cargo01

Panel ID	Date	Nickname
▲ #635	29/03/2019	RIX02

Panel ID	Date	Nickname
#546	29/03/2019	Tallinn1
#541	17/04/2019	cargo2
#635	31/03/2019	RIX02